

HYDRAULIC BRAKE

ASSEMBLY

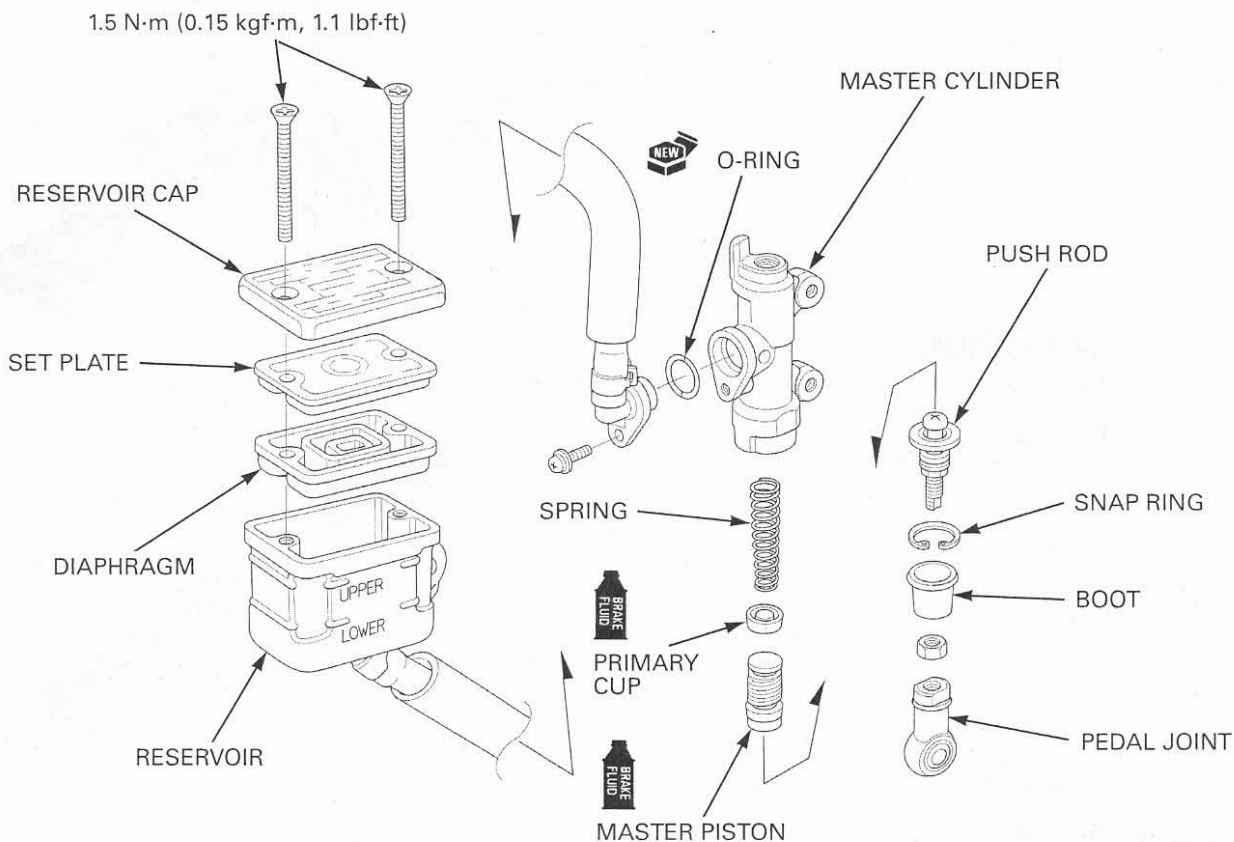

- Keep the piston, cups, spring, snap ring and boot as a set; do not substitute individual parts.

Coat the master piston and piston cups with clean brake fluid.

Install the primary cup to the spring.

When installing the cups, do not allow the lips to turn inside out.

Install the spring/primary cup and master piston into the master cylinder.

Apply silicone grease to the piston contact area of the push rod.

Install the push rod assembly into the master cylinder.

Install the snap ring using the special tool.

Be certain the snap ring is firmly seated in the groove.

TOOL:
Snap ring pliers

07914-SA50001

Apply silicone grease to the push rod boot inside.
Install the boot into the master cylinder.

