

# Seat Removal

Refer to *Safety Precautions* on page 84 .

The seat must be removed for the air cleaner maintenance.

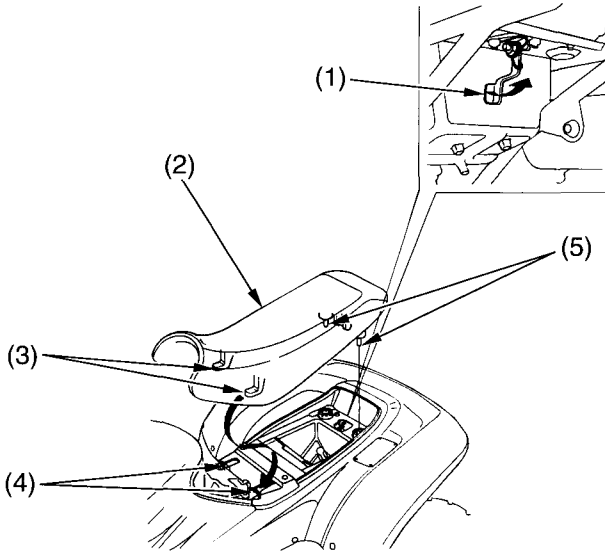

(1) seat lock lever

(2) seat

(3) front prongs

(4) hooks

(5) studs

## Removal

1. Pull up the seat lock lever ( 1 ) behind the seat.
2. Slide the seat ( 2 ) back and lift it.

## Installation

1. Insert the front prongs ( 3 ) into the hooks ( 4 ) on the frame and press the studs ( 5 ) into the grommets on the storage compartment.
2. Press down on the seat until locks.