



Brakes

Right Side Mudguard Removal

Refer to *Safety Precautions* on page 77 .

The right side mudguard must be removed to adjust the rear brakelight switch.

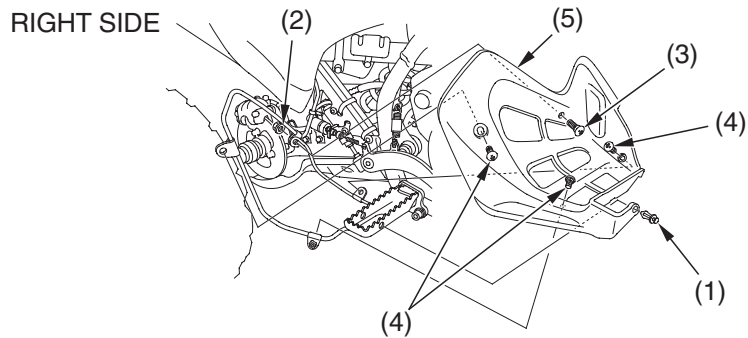

- (1) clip (3) screw A (5) right side mudguard
(2) nut (4) screws B

Removal

1. Remove the clip (1), the nut (2), and screw A (3).
2. Remove the screws B (4) and right side mudguard (5).

Installation

Install the right side mudguard in the reverse order of removal.

