

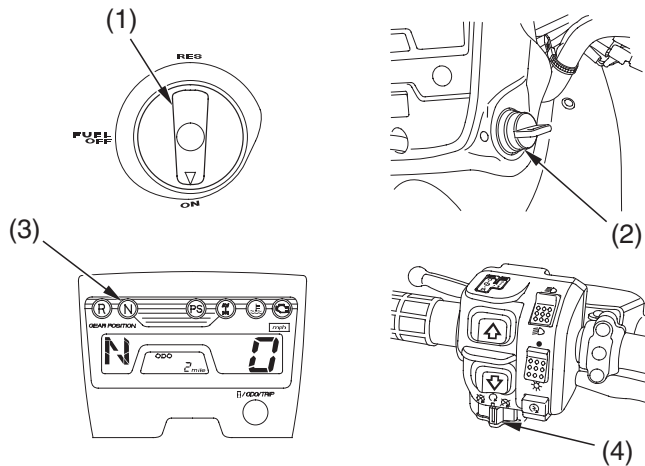

Starting & Stopping the Engine

Preparation



- (1) fuel valve
- (2) ignition switch
- (3) neutral indicator
- (4) engine stop switch

1. Before starting, select a level surface and lock the parking brake (page 34).
2. Turn the fuel valve (1) and ignition switch (2) to ON (|).

Confirm the following:

- The transmission is in neutral, and the neutral indicator (3) is ON.
- The engine stop switch (4) is set to RUN (O).