



## Seat Removal

---

Refer to *Safety Precautions* on page 75 .

The seat must be removed for the air cleaner, battery and fuse maintenance, and to access the tool kit and owner's manual.

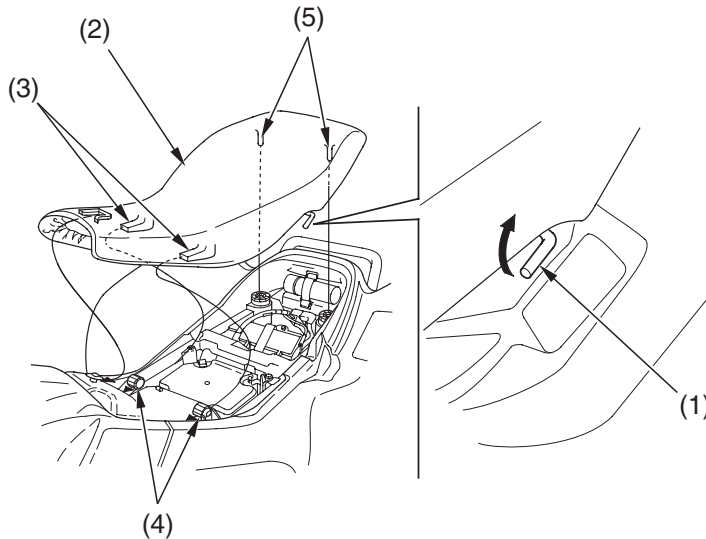

- (1) seat lock lever
- (2) seat
- (3) front prongs

- (4) hooks
- (5) studs

### Removal

1. Pull the seat lock lever ( 1 ) at the left side of the seat.
2. Slide the seat ( 2 ) back and lift it.

### Installation

1. Insert the front prongs ( 3 ) into the hooks ( 4 ) on the frame and press the studs ( 5 ) into the grommets on the frame.
2. Press down on the seat until locks.

