

FEATURES (Not required for operation)

CASSETTE DECK

Loading

Push the eject button to open the cassette lid and slide the tape into the deck, following the inserting direction shown on the lid.

CAUTION:

- ***Check there is no slack in the tape before inserting the cassette tape into the deck.***
- ***Make sure the lid is secured after inserting the cassette tape into the deck.***
- ***Do not open the cassette lid in the rain. Before opening the cassette lid, wipe off any dirt or water on the outer surface.***
- ***The use of 120-minute cassette tapes is not recommended. If necessary to use 120-minute tapes, do not switch the tape operation mode frequently. Most 120-minute tape stretches easily and can become tangled in the player mechanism.***

Eject Button

The cassette is ejected from the deck when this button is depressed.

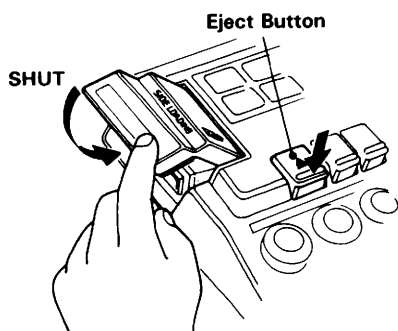

Inserting Direction

