

# Engine Oil

## Checking & Adding Oil

RIGHT SIDE

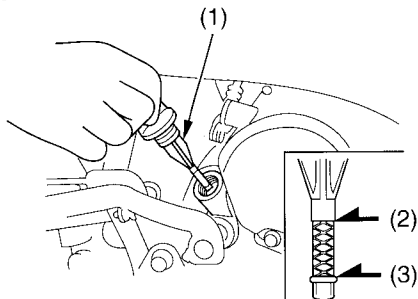

- (1) oil filler cap/dipstick
- (2) upper level mark
- (3) lower level mark

1. Park your motorcycle on a firm, level surface.
2. Clean around the oil filler cap/dipstick ( 1 ) and nearby surfaces.

3. Start the engine and let it idle for 3—5 minutes. Stop the engine. Wait 2—3 minutes.
4. Immediately unscrew and remove the oil filler cap/dipstick. Wipe it clean.
5. Hold the motorcycle upright.
6. Insert the oil filler cap/dipstick until it seats, but do not screw it in.
7. Remove the oil filler cap/dipstick and check the oil level.
  - If the oil is at or near the upper level mark ( 2 ), you do not have to add oil.
  - If the oil is below or near the lower level mark ( 3 ), add the recommended oil until it reaches the upper level mark. (Do not overfill.)