

LOWER COWL

The right and left lower cowls can be removed in the same manner.

Removal:

1. Remove the middle cowl (page 74).
2. Remove the inner lower cowl (page 76).
3. Remove the clips A (1).
4. Remove the bolt A (2) and bolt B (3).
5. Remove the lower cowl (4).

Installation:

- Installation can be done in the reverse order of removal.

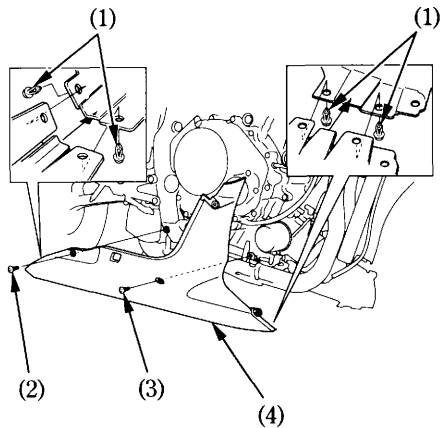

- (1) Clips A
- (2) Bolt A
- (3) Bolt B
- (4) Lower cowl