

FUEL

Fuel Tank

The fuel tank is located under the seat. Fuel tank capacity is:

3.7 ℓ (0.98 US gal , 0.81 Imp gal)

Open the seat (page 39). Remove the fuel fill cap (1) by turning it counterclockwise.

Do not overfill the tank. There should be no fuel in the filler neck (2).

After refueling, be sure to tighten the fuel fill cap firmly by turning it clockwise.

Make sure that the arrow marks (3) on the fuel fill cap and fuel tank is aligned.

⚠ WARNING

Petrol is highly flammable and explosive. You can be burned or seriously injured when handling fuel.

- Stop the engine and keep heat, sparks, and flame away.
- Refuel only outdoors.
- Wipe up spills immediately.

NOTICE

Do not remove the fuel pump cover.

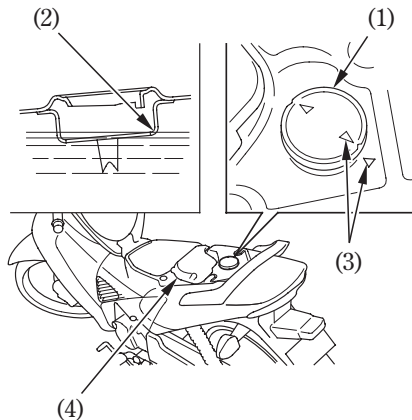

- (1) Fuel fill cap
- (2) Filler neck
- (3) Arrow marks
- (4) Fuel pump cover